



Adapter Sub-D 9 pin male > female 270° angled

Description

This serial adapter by Delock enables you to angle the female port of your serial device by 270°. Thus you can connect your serial cable without any problem in case the existing serial female port is difficult to access.



Ref.	65265
EAN	4043619652655
Country of origin	China
Customs tariff number	84718000

Images

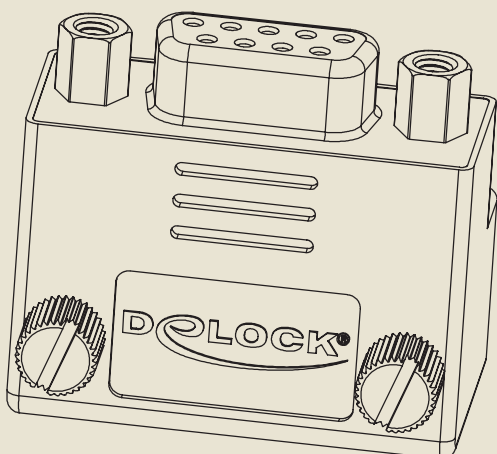
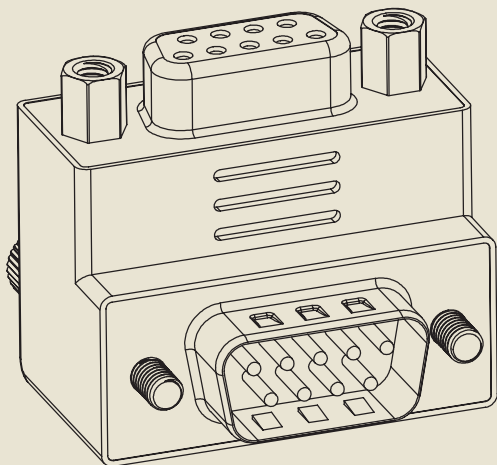

Specification

- Connector: Sub-D 9 pin male > Sub-D 9 pin female
- Female port 270° angled
- Sub-D 9 female with screw nuts
- Sub-D 9 male with screws

Package content

- Adapter Sub-D 9 pin

Package

- Delock poly bag